

\$ - B6 - 20 Meadowglen Place, Toronto (woburn)

MLS® #E8375868

\$

0 Bedroom, 0.00 Bathroom, 762 sqft
Retail

Woburn, Toronto (woburn), Ontario

This New Mixed-Use Community With Prime Retail Space On The Main Floor Is Strategically Located In Close Proximity To Highway #401.Minutes Away From Shopping Centers, Financial And Educational Institution. T.M.I Is An Estimate ****EXTRAS**** Other available units: U#B4 - 773 SF / U#B5 - 801 SF / U#B4-B5 = 1,574 SF / U#B5-B6 = 1,563 SF / U#B4-B6 = 2,337 SF (Based on rentable area). (id:6289)

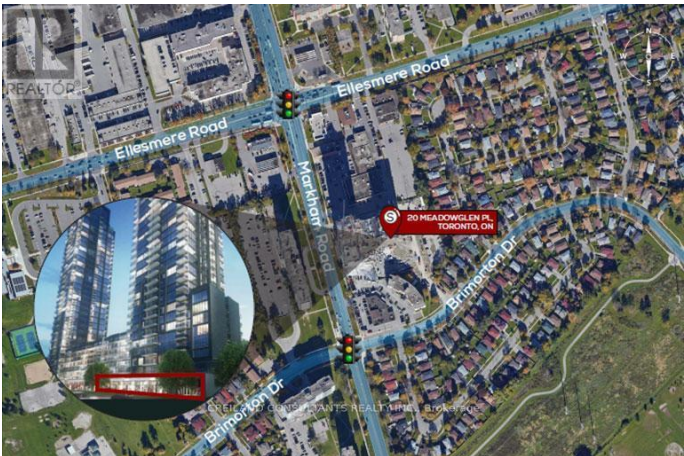

Essential Information

Listing #	E8375868
Bathrooms	0.00
Square Footage	762
Type	Retail

Community Information

Address	B6 - 20 Meadowglen Place
Subdivision	Woburn
City	Toronto (woburn)
Province	Ontario
Postal Code	M1H2Y5

Amenities

Parking	Underground
---------	-------------

Interior

Heating	Natural gas Other
Cooling	Fully air conditioned

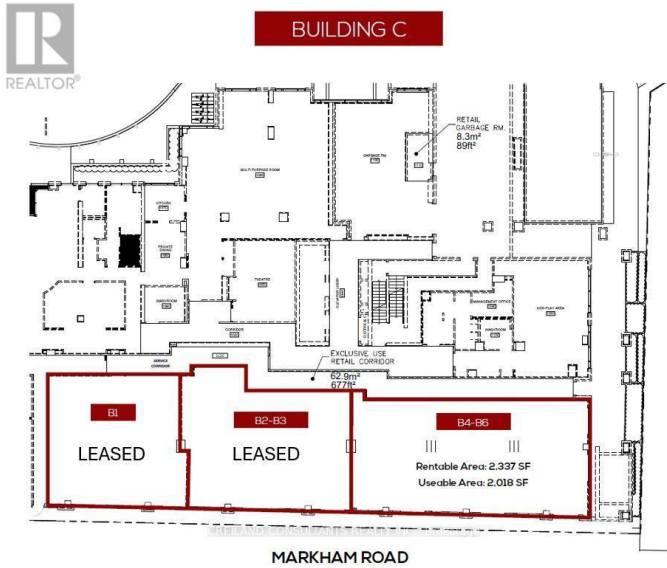

Listing Details

Listing Office CREILAND CONSULTANTS REALTY INC.



The trademarks MLS®, Multiple Listing Service® and the associated logos are owned by The Canadian Real Estate Association (CREA) and identify the quality of services provided by real estate professionals who are members of CREA. REALTOR®. Member of CREA and more.

Listing information last updated on October 15th, 2025 at 2:46am EDT