

\$3,600,000 - 11 Main St (432/438 Davis) E, Newmarket (central Newmarket)

MLS® #N12046547

\$3,600,000

0 Bedroom, 0.00 Bathroom,
Multi-family on 0.00 Acres

Central Newmarket, Newmarket (central Newmarket), Ontario

Hello Developers and Investors, excited to bring to your attention a very rare opportunity to own an assembly of lands located within the Urban Centres Secondary Plan. This plan identifies that the subject properties are within the Davis Drive Character Area, which permits a variety of uses including low to mid-rise residential, retail, office, live-work, places of entertainment, and post-secondary facilities. Building heights are permitted to range from 3 to 8 storeys, with densities of 1.5 to 2.0 FSI. Additionally, with bonusing, heights can be increased to 10 storeys. (id:6289)

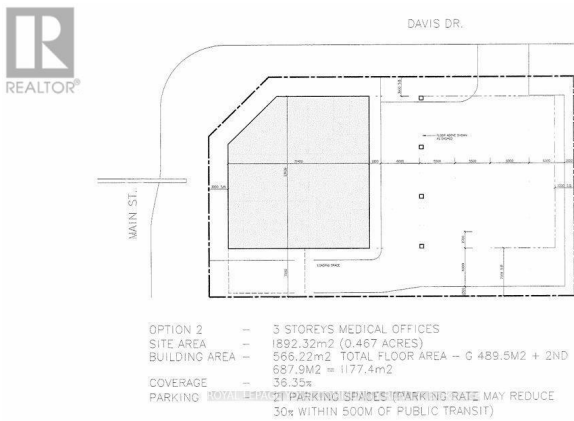

Essential Information

Listing #	N12046547
Price	\$3,600,000
Bathrooms	0.00
Acres	0.00
Type	Multi-family

Community Information

Address	11 Main St (432/438 Davis) E
Subdivision	Central Newmarket
City	Newmarket (central Newmarket)
Province	Ontario
Postal Code	L3Y3Y1

Amenities

Parking	Detached Garage, Garage
# of Garages	2

Interior

Heating	Other
---------	-------

Exterior

Lot Description	243 x 133 FT ; Irregular
Foundation	Unknown

Listing Details

Listing Office	ROYAL LEPAGE YOUR COMMUNITY REALTY
----------------	------------------------------------



The trademarks MLS®, Multiple Listing Service® and the associated logos are owned by The Canadian Real Estate Association (CREA) and identify the quality of services provided by real estate professionals who are members of CREA. REALTOR®. Member of CREA and more.

Listing information last updated on October 14th, 2025 at 11:31am EDT